

HRH1342M

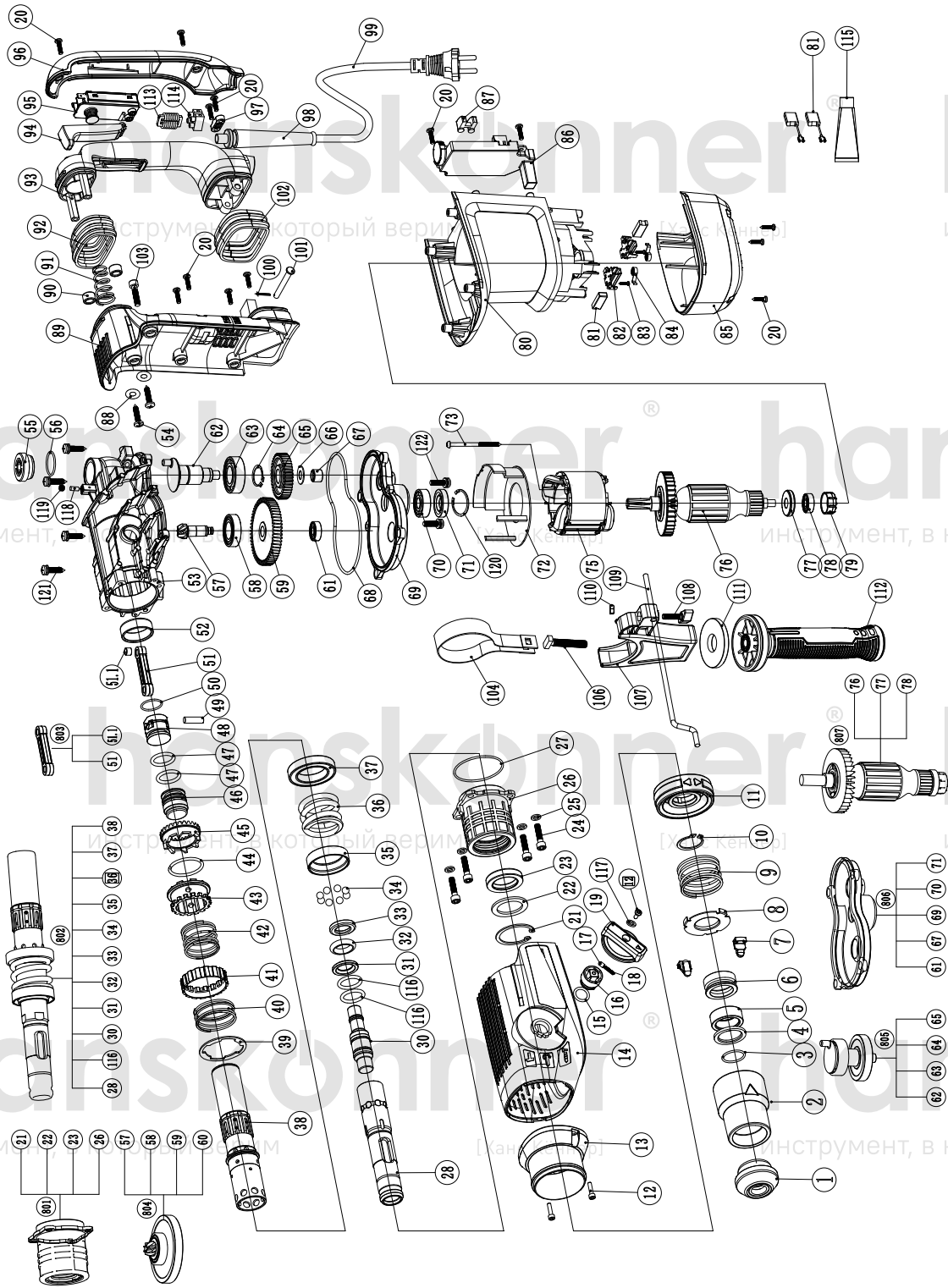

No.	Description	No.	Description
1	Hammer rod protector	65	Crankshaft gear
2	Flex Sheath	66	Crankshaft gear Washer
3	Retaining Ring Ф26	67	Needle Bearing HK101410
4	Support Washer	68	Airproof Ring
5	Rubber Ring	69	Inner Cover
6	Lock Bead Sheath	70	Ball Bearing NSK 6201 DDU
7	Insert block	71	Oil Seal Ring Ф17×Ф32×7
8	Spring Rack	72	Fan Guide
9	Flex Sheath Spring	73	Tapping Screw ST4.8×58
10	Retaining Ring Ф28	75	Stator (220V-240V)
11	Selector	76	Armature (220V-240V)
12	Hex .Socket Bolt M4×16	77	Magnetism Inductorium
13	Front Shade	78	Ball Bearing 608LBV CW
14	Cover	79	Bearing Ring
15	Fluorin O Ring Ф13.94×Ф2.62	80	Housing
16	Dial Staff Sheath	81	Carbon Brush (220V-240V)
17	Copper sleeve	82	Carbon brush wire
18	Function Knob Spring	83	ST3.5 × 12 Cross recessed pan head tapping screws
19	Function Knob	84	Coil spring
20	Tapping Screw ST4.2×16	85	Fan Cover
21	Retaining Ring Ф42	86	Speed Adjuster (220V-240V)
22	Woolen Ring Ф30×Ф42×3	87	Indicator
23	Oil Seal RingФ30xФ42x8	88	Flat WasherФ6xФ14x1.6
24	Hex .Socket Bolt M6×25 (12.9)	89	Main Handle Seat
25	Flat Washer Ф6×Ф10.5	90	Shock Absorption Ferrule
26	Front housing	91	Shock Absorption Spring
27	Fluorin O RingФ54.5×Ф2.2	92	Shock Absorption Jacket
28	Hammer Staff Sheath	93	Main Handle
30	Impact Hammer	94	Switch Trigger
31	Hammer ring	95	Switch (220V-240V)
32	Vibration Reducing Cushion	96	Main Handle Cover
33	Limit ring	97	Cord Clip
34	Steel Ball SФ7.938	98	Cord Armor
35	Check Ring	99	Cord
36	Spring	100	Ф2×14 Split Pin
37	Ball Bearing 6907RS	101	Ф6×50 Shaft Pin
38	Cylinder	102	Bottom Shock Absorption Jacket
39	Ratchet Spring Ring	103	Hex .Socket Bolt M6×20
40	Ratchet Spring	104	Side Handle Ass' y Steel Tie
41	Ratchet Ring	106	"T" Bolt M8×45
42	Clutch Spring	107	Side Handle Ass' y Base
43	Clutch	108	Papilionaceous Bolt
44	Steel Wire Block Ring Ф32	109	Orientation Staff Guage
45	Big Cone-shaped Gear	110	Nut M6
46	Impact Piston	111	Side Handle cover
47	Fluorin O Ring Ф21.3xФ3.5	112	Side Handle
48	Gas Press Piston	113	Electricity Feels
49	Piston Pin	114	Rivet
50	Fluorin O Ring Ф22×Ф2	115	Oil Bottle
51	Connecting Rod Ass' y	116	Y RingФ15.8xФ22.8xФ3.5
51.1	Press Sleeve	117	Ф4 Flat Washer
52	Oilliness Bearing Ф32×Ф37×12	118	Wool blockФ4.5×11
53	Crank Housing	119	M6×5Seal Lock Screw
54	ST5.5×25 Plum head tapping Screws	120	Retaining Ring Ф32
55	Oil Tank Cover	121	ST5.5×30 flat head wide tooth cross head screw triple
56	silicon Washer φ31xp25x2.2	122	M5x18 hexagon socket head cap screw triple combination (12.9)
57	Small Cone-shaped Gear	801	Front housingSubassembly
58	Ball Bearing 6904 VV	802	Impact structure Subassembly
59	Final Gear	803	Connecting Subassembly
61	Ball Bearing 608 RS	804	Small Cone-shaped GearSubassembly
62	Crank Shaft	805	Crankshaft gear Subassembly
63	Ball Bearing 6004	806	Inner Cover Subassembly
64	Retaining Ring Ф20×1	807	Armature Subassembly 220-240V